



## Canadian Sheep Breeders' Association

RR 2, Site 7, Box 46 Bluffton, AB T0C 0M0  
Toll free: 1-866-956-1116 Fax: 1-877-207-2541  
office@sheepbreeders.ca www.sheepbreeders.ca

### La Société Canadienne des Éleveurs de Moutons

Press Release

#### Shearwell CSIP Double Tags – Now Available

The Shearwell double tag is now available for purchase through the Canadian Cooperative Wool Growers Limited. Many CSBA members have been anxiously awaiting the approval of the Shearwell double tag due to its small size and excellent reputation for rate of retention.

CSBA members may use a double tagging system with two tags approved and bearing the official identification number under the Canadian Sheep Identification Program as an alternative for tattooing registered sheep. While the option to use approved double tags in place of tattoos has been in effect since October 2006, only Allflex double tags were approved until now.

#### Shearwell CSIP Double Tag details:

- Sold in sets of 20 (40 tags in total)
- Must be taken off of the strip in consecutive pairs with matching numbers
- The RFID tag is marked with the CSIP maple leaf emblem
- The RFID tag must be placed in the right ear
- The companion tag (no maple leaf emblem) must be placed in the left ear
- Confirm that both tags bear the same number before application
- A new, black insert for the Shearwell tag pliers will be required for tag application

The registration application must include the national ID number, which will be recorded on the registration paper in place of the tattoo. The animal's name should still include a within-flock number, followed by the designated year letter used to signify the year of birth.

Lost tags must be replaced within 21 days with a duplicate tag bearing the same national ID number. CSBA members should contact the CSBA to order replacement tags or complete the online order form on the CSBA's website. The CSBA will place the order with Shearwell and collect payment from the member.

Please contact the CSBA if you have any questions: 1-866-956-1116.

Thank you for purchasing your RFID tags for sheep.

### RECOMMENDED STORAGE INSTRUCTIONS

To allow easy application, these tags should be stored in a warm dry environment. If stored in damp conditions, the tags may become overly flexible. If stored in cold or very dry conditions, the tags may become brittle. If these occur then place the tags in the correct environment and the plastic will return to optimum condition.

Should you have any difficulties with these tags, please contact your tag supplier, or the

Canadian Co-operative Wool Growers for further assistance.

Lethbridge, AB  
1-800-567-3693

Carleton Place, ON  
1-800-488-2714

Cookstown, ON  
1-866-458-4800



[www.wool.ca](http://www.wool.ca)  
[www.premier-choix.ca](http://www.premier-choix.ca)

#### New Shearwell ASET Tags And Tag Applicators



Shearwell Data Ltd. (SDL) has advised us of slight changes to the CSIP-approved SET tag. Based on feedback from users there have been improvements made to the current ESET tag.

Improvements to the new ASET tag:

1. Spike is 1 mm longer to reduce pinching when the tag is closed on thick-eared sheep.
2. Body of tag is thicker on the spike end to reduce the possibility of tags bending when being applied in warm weather.
3. Overall tag length is slightly longer to help with bigger ears, plus increase accuracy and reduce bending when closing the tag.
4. An additional bump on the underside of the tag for fitting into the automatic applicator.

The new ASET tags need a different jaw insert in the applicator. The new jaw inserts are black so it is easy to tell if you are using the right applicator for the right tags; BLACK jaws for the new ASET tags, GREEN jaws for the original ESET tag.

#### DO IT RIGHT

- Use the **RIGHT** RFID tag
- Use the **RIGHT** tag applicator
- Apply the tag in the **RIGHT** position on the **RIGHT** ear of the sheep

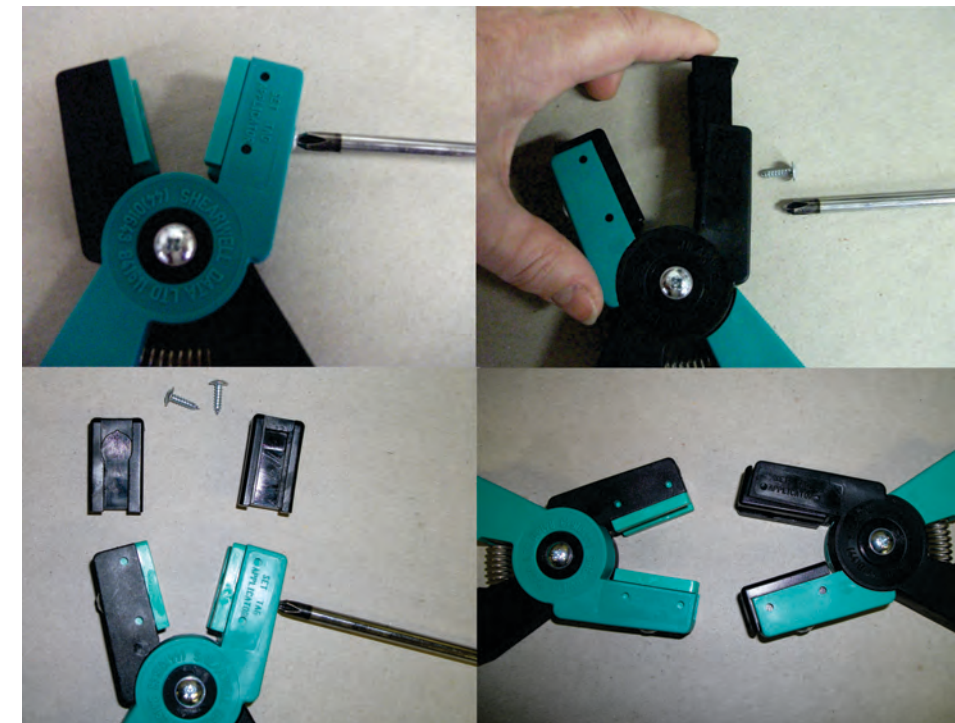

To change over to BLACK insert:

Remove the screw from top and bottom jaws. Slide out the GREEN insert and slide in the new BLACK insert. Replace the screws top and bottom.



# RFID ear tags for sheep

## Instructions for Inserting Sheep ASET Tags

These are the two RFID (*radio frequency identification*) ear tags approved by the Canadian Sheep Identification Program

It is important to pay attention to the correct tagging procedures for sheep. Generally sheep should not be tagged in hot weather and when fly strike is possible. Tagging at birth is recommended.

Allflex sheep button tag

Shearwell Data Ltd ASET loop tag

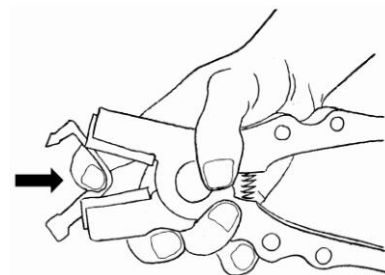

1. Disinfect the tag and load the tag making sure each end clicks into place.
2. Hold the sheep securely.
3. In young lambs place the tag on the upper edge of the ear (this is the strongest edge), 1/3<sup>rd</sup> from the base and 2/3<sup>rd</sup> from the tip.



4. If you think that the top of the ear will outgrow the pin length, place the tag at the back of the ear.
5. For older sheep it may be necessary to apply to the back of the ear if the top is too thick for the tag pin.

### Button tags:

- Are sold as a two-part set - make sure the number on the back matches the number on the front.
- Put the tag between the cartilage (ribs) of the ear.

### ASET Loop tags:

- Put the tag on the top of the ear.
- Leave room for the ear to grow when tagging baby lambs.

### For best tag retention follow manufacturer's directions:

1. Use the correct tag applicator supplied by the manufacturer.
2. Tags should be applied in the first third of the ear, close to the head.
3. Tags should be applied between the cartilage (ribs) of the ear.
4. The transponder should be on the inside of the ear.

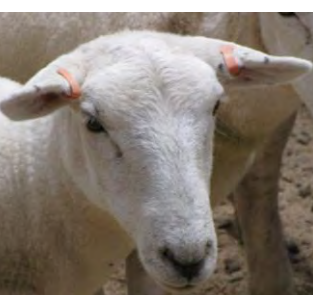

6. Please make sure that the length of the pin is suitable for your sheep before inserting the tag.
7. The point of the tag should go in from the outside of the ear. Once applied, the point will be on the inside of the ear.

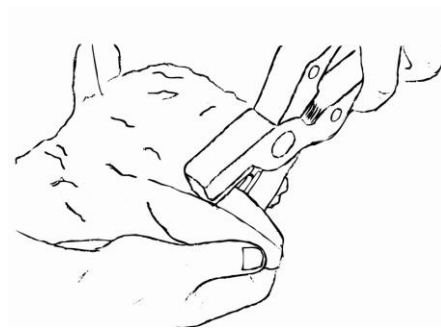

8. Avoid piercing the ridge of cartilage along the top of the ear, as this may deform the ear and may also result in infection.

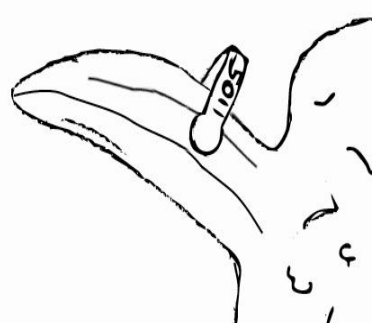

9. When tagging the sheep it must be remembered that the ear will grow, therefore let it hang 4-5 mm over the edge of the ear when applying to lambs. (This may need to be more for larger eared breeds.)



### For best RFID tag reading:

1. Animals should have only one RFID ear tag.
2. Apply RFID tag in the animal's right ear.